

RMC series male thread

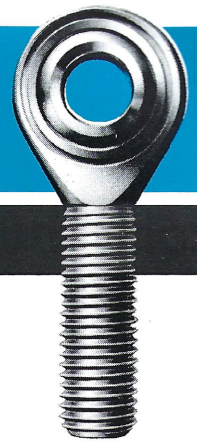

Specification

- Housing** Manganese molybdenum steel.
Phosphated all over.
- Ball** 1% carbon chromium steel.
Heat treated.
Chromium plated on the spherical surface.
- Liner** Reinforced PTFE.
- Stainless steel** All the units on this page are available in stainless steel. The last letter of the designation changes from C to R. All dimensions are unchanged.

Temperature and fits

The normal maximum operating temperature for these rod ends is 120°C, although Rose Bearings technical department should be consulted where the normal operating temperature exceeds 80°C.

There is no measurable clearance in these rod ends in the no load condition, and the tightness of the rod end is measured by the breakaway torque as indicated below.

Bearing size No load breakaway torque (lbf in)

RMC

04-10

0-5

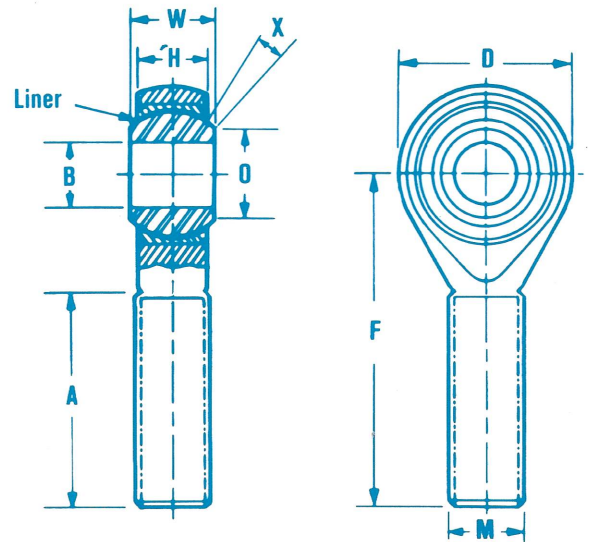

Imperial dimensions

Bearing number	Racing Car series equivalent	B	W	H	O	D	F	A	M	X	Ball dia nom	Maximum static radial load in pounds approx	Weight in pounds each approx
		Bore	Ball width	Housing width	Ball flat dia	Head dia	Centre length	Thread length	Thread size	Angle deg			
RMC 04NU	RC 04H	.2500	.375	.281	.355	.812	1.562	1.000	.250-28	16.5	.516	2890	.055
RMC 04U	RC 04	.2500	.375	.281	.355	.812	1.562	1.000	.312-24	16.5	.516	3880	.058
RMC 05NU	RC 05H	.3125	.437	.344	.447	1.000	1.875	1.250	.312-24	13.5	.625	4680	.092
RMC 05U	RC 05	.3125	.437	.344	.447	1.000	1.875	1.250	.375-24	13.5	.625	6470	.100
RMC 06NU	RC 06H	.3750	.500	.406	.517	1.125	1.938	1.250	.375-24	12.0	.719	7070	.137
RMC 06U	RC 06	.3750	.500	.406	.517	1.125	1.938	1.250	.437-20	12.0	.719	8190	.151
RMC 06FU	RC 06F	.3750	.500	.406	.517	1.125	1.938	1.250	.500-20	12.0	.719	8190	.167
RMC 07NU	RC 07H	.4375	.562	.437	.586	1.250	2.125	1.375	.437-20	13.0	.812	9850	.190
RMC 07U	RC 07	.4375	.562	.437	.586	1.250	2.125	1.375	.500-20	13.0	.812	10050	.208
RMC 08NU	RC 08H	.5000	.625	.500	.698	1.375	2.438	1.500	.500-20	11.0	.937	11200	.270
RMC 08U	RC 08	.5000	.625	.500	.698	1.375	2.438	1.500	.625-18	11.0	.937	11200	.310
		+0015 -0005	+000 -005	+005 -005		+010 -010	+015 -015	+060 -030	UNF 2A				
RMC 10NU	RC 10H	.6250	.750	.562	.832	1.625	2.625	1.625	.625-18	13.5	1.125	14700	.494

For left hand thread insert L in bearing number eg. RMLC 05U.

For BSF threads on Imperial units delete letter U, eg. RMC 05.

Other bearings outside the above range can be obtained, but will not be so readily available.